

## HARD SURFACE MOUNT CEILING OR SIDEWALL APPLICATION | FLANGED



In a flanged application, the DFL flange will overlap the hard surface and be visible from the room side.

Listed below are the different frame and mounting combinations that can create this appearance.

### OPTION #1 - Frame CC with H1 Clips

- Provides 3/16" overlapping flange
- Must be installed before drywall

### OPTION #2 - Frame FF with H1 Clips

- Provides 1/2" overlapping flange
- Must be installed before drywall

### OPTION #3 - Frame FF with CF (Concealed Fastening)

- Provides 1/2" flange
- Installed after drywall

## FRAME DETAIL

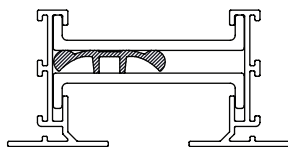

**FRAME CC**  
3/16" Overlapping Flange

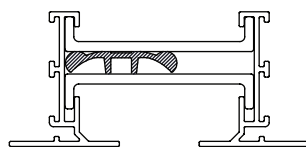

**FRAME FF**  
1/2" Overlapping Flange

## CONCEALED FASTENING DETAIL

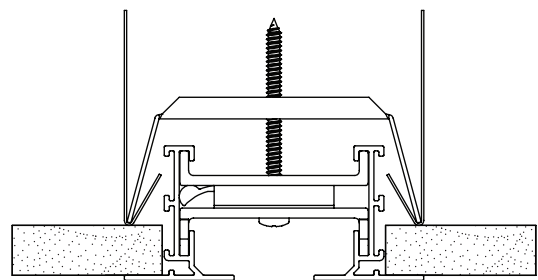

## CLIP DETAIL

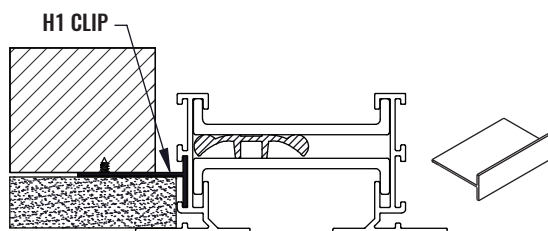

## HARD SURFACE MOUNT CEILING OR SIDEWALL APPLICATION | FLUSH



In a flush mount application, the DFL does not protrude into the room, as the visible flange is recessed into the hard surface.

Listed below are the different frame and mounting combinations that can create this appearance.

### OPTION #1 - Frame AA with H2 Clips

- Provides flush look with face size equal to neck size
- Must be installed prior to drywall / hard surface

### OPTION #2 - Frame CC with H2 Clips

- Provides flush look with face size slightly larger than neck size
- Must be installed prior to drywall / hard surface

## FRAME DETAIL

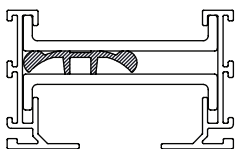

**FRAME AA**

No Overlapping Flange

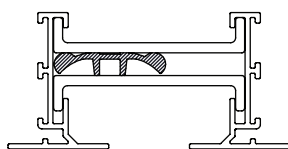

**FRAME CC**

3/16" Overlapping Flange

## CLIP DETAIL

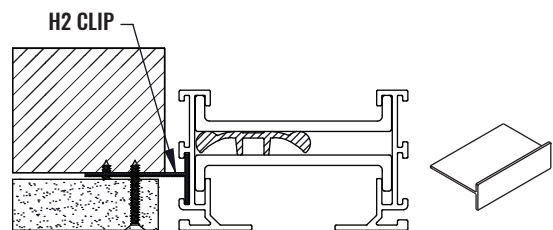

## HARD SURFACE MOUNT CEILING OR SIDEWALL APPLICATION | FLANGELESS



In a flangeless application, the DFL flange will be taped and spackled to blend in with the surrounding architecture, leaving only the slot(s) visible from the room side.

Listed below are the different frame and mounting combinations that can create this appearance.

### OPTION #1 - Frame BB (1", 1-1/2", 2") with H1 Clips

- Must be installed prior to drywall / hard surface
- Must be properly taped and spackled

### OPTION #2 - Frame BB (2-1/2" & 3") with H3 Clips

- Must be installed prior to drywall / hard surface
- Must be properly taped and spackled

### OPTION #3 - Frame EE with H3 Clips

- Must be installed prior to drywall / hard surface
- Drywall / hard surface must be cut at angle to fit frame

### OPTION #4 - Frame BB with CF (Concealed Fastening)

- Installed after drywall / hard surface
- Must be properly taped and spackled
- Spackling can crack if plenum is not properly secured to framing

## FRAME DETAIL

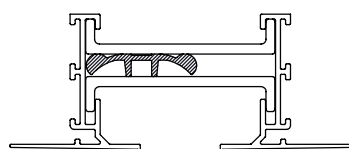

**FRAME BB**  
Mud-in Flange

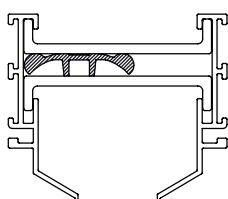

**FRAME EE**  
Concealed Beveled Frame

## CONCEALED FASTENING DETAIL

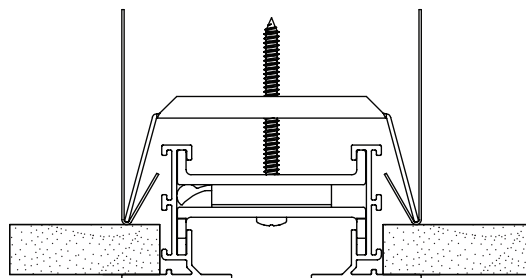

## CLIP DETAIL

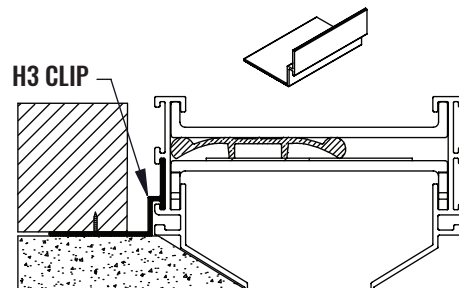
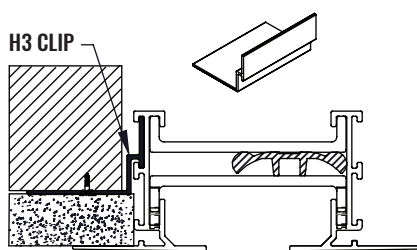
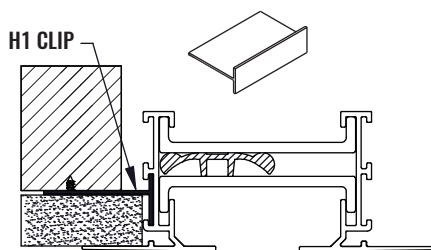

## EXPOSED OR WOOD/METAL SLAT CEILING APPLICATION



In a wood or metal slat ceiling application, the DFL will hang from the ceiling structure to where the face is flush with surrounding ceiling slats. With its black internal components, the DFL will appear as though it is floating.

Listed below are the different frame and mounting combinations that can create this appearance.

### OPTION #1 - Frame AA, CC, or FF with US Hangers

- Wire provided by others
- Must securely hang from upper structure
- US Hangers installed individually on each side of DFL
- See DFL submittal for dimension of visible flange

### OPTION #2 - Frame AA, CC, or FF with UC Hangers

- Wire provided by others
- Must securely hang from upper structure
- UC Hanger attaches to both sides of DFL
- UC Hanger must be installed outside of plenum ends or in gaps between plenums
- See DFL submittal for dimension of visible flange

## FRAME DETAIL

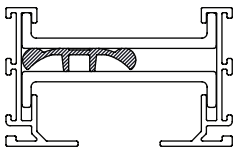

**FRAME AA**  
No Overlapping Flange

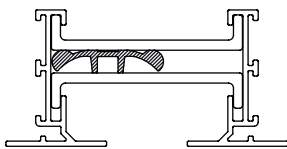

**FRAME CC**  
3/16" Overlapping Flange

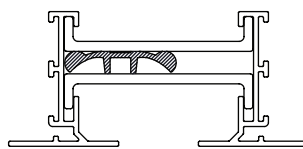

**FRAME FF**  
1/2" Overlapping Flange

## HANGER DETAIL

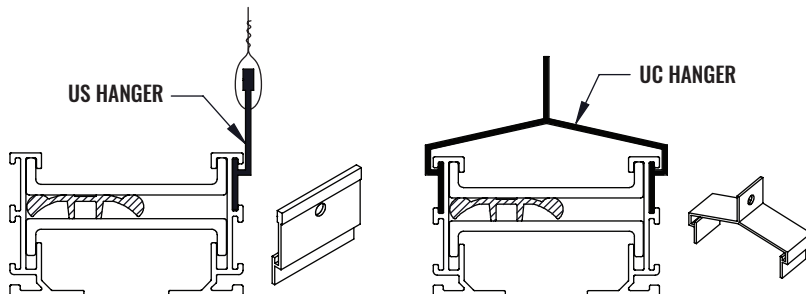



## 15/16" T-BAR CEILING APPLICATION | FLAT/FLUSH FACE



In a 15/16" T-bar application, the DFL will be sized and selected to sit flush onto the surrounding 15/16" T-bar grid. DFL order lengths can be easily identified by using the [DFL Lay-In Sizing Calculator](#).

Listed below are the different frame and mounting combinations that can create this appearance.

### OPTION #2 - Frame AA, CC, or FF with US Hangers

- Wire provided by others
- Must securely hang from upper structure
- US Hangers installed individually on each side of DFL
- See DFL submittal for dimension of visible flange

### OPTION #2 - Frame AA, CC, or FF with UC Hangers

- Wire provided by others
- Must securely hang from upper structure
- UC Hanger attaches to both sides of DFL
- UC Hanger must be installed outside of plenum ends or in gaps between plenums
- See DFL submittal for dimension of visible flange

CEILING VIEW CROSS SECTION



## FRAME DETAIL

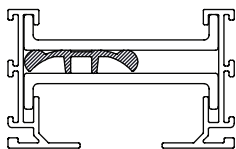

FRAME AA

No Overlapping Flange

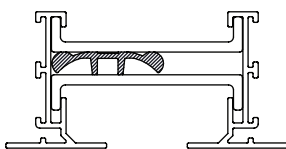

FRAME CC

3/16" Overlapping Flange

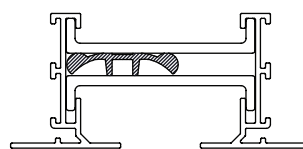

FRAME FF

1/2" Overlapping Flange

## HANGER DETAIL

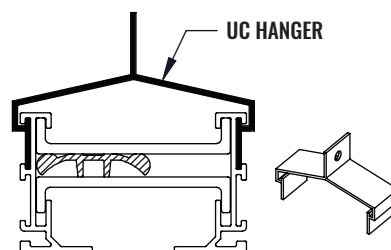
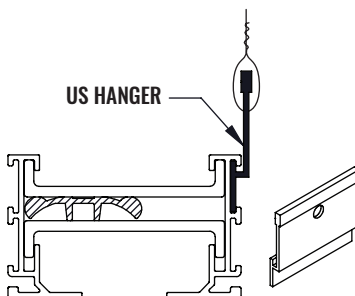

## 9/16" T-BAR CEILING APPLICATION | DROP FACE OR BOLT SLOT

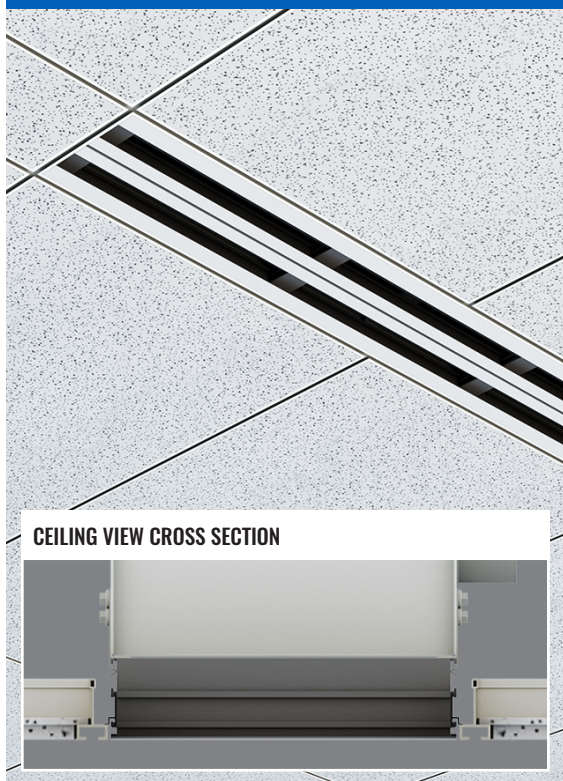

In a 9/16" T-bar application, the DFL will be sized and selected to drop below a flat 9/16" T-bar grid or be flush with the room side edge of a 9/16" bolt slot T-bar grid. DFL order lengths can be easily identified by using the [DFL Lay-In Sizing Calculator](#).

Listed below are the different frame and mounting combinations that can create this appearance.

### OPTION #1 - Frame AA with SC Clips

- SC Clip sits on 9/16" T-bar

### OPTION #2 - Frame AA, CC, or FF with US Hangers

- Wire provided by others
- Must securely hang from upper structure
- US Hangers installed individually on each side of DFL
- See DFL submittal for dimension of visible flange

### OPTION #3 - Frame AA, CC, or FF with UC Hangers

- Wire provided by others
- Must securely hang from upper structure
- UC Hanger attaches to both sides of DFL
- UC Hanger must be installed outside of plenum ends or in gaps between plenums
- See DFL submittal for dimension of visible flange

## FRAME DETAIL

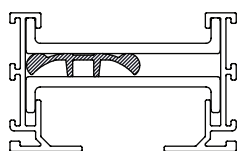

**FRAME AA**  
No Overlapping Flange

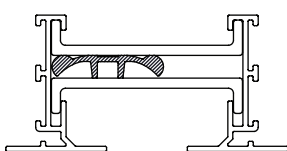

**FRAME CC**  
3/16" Overlapping Flange

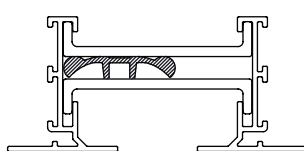

**FRAME FF**  
1/2" Overlapping Flange

## HANGER & CLIP DETAIL

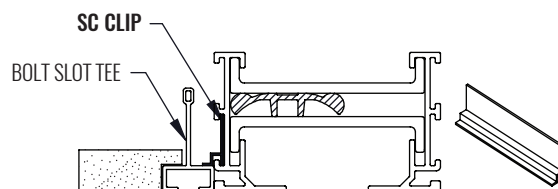
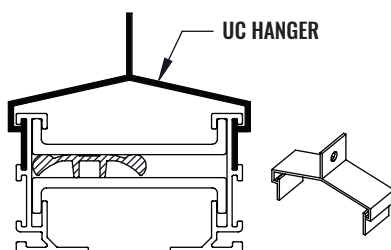
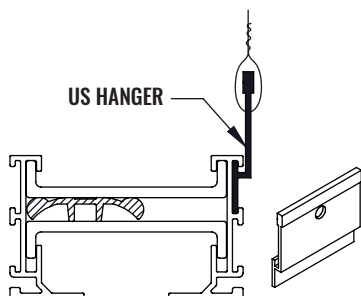

## EXPOSED CEILING APPLICATION



In an exposed ceiling application, the DFL will hang from the ceiling structure so that the face of the DFL is at the required distance from the floor. With its black internal components, the DFL will appear as though it is floating.

Listed below are the different frame and mounting combinations that can create this appearance.

### OPTION #1 - Frame AA, CC, or FF with US Hangers

- Wire provided by others
- Must securely hang from upper structure
- US Hangers installed individually on each side of DFL
- See DFL submittal for dimension of visible flange

### OPTION #2 - Frame AA, CC, or FF with UC Hangers

- Wire provided by others
- Must securely hang from upper structure
- UC Hanger attaches to both sides of DFL
- UC Hanger must be installed outside of plenum ends or in gaps between plenums
- See DFL submittal for dimension of visible flange

## FRAME DETAIL

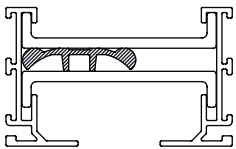

**FRAME AA**  
No Overlapping Flange

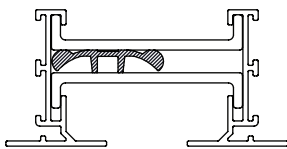

**FRAME CC**  
3/16" Overlapping Flange

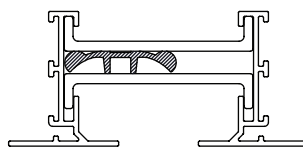

**FRAME FF**  
1/2" Overlapping Flange

## HANGER DETAIL

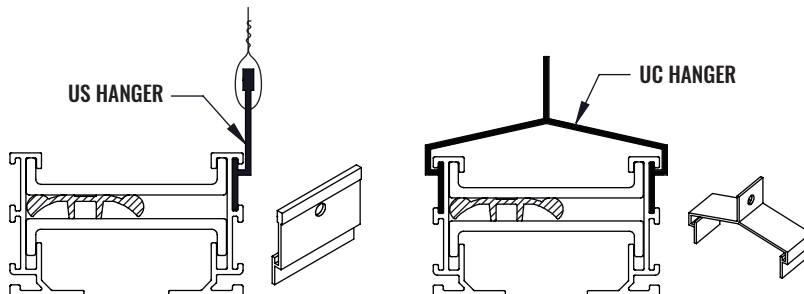

## EXPOSED OR WOOD/METAL SLAT CEILING APPLICATION



In an exposed or wood/metal slat ceiling application, the DFL will hang from the ceiling structure to where the face is flush with surrounding ceiling structure or ceiling slats. With its black internal components, the DFL will appear as though it is floating.

Listed below are the different frame and mounting combinations that can create this appearance.

### OPTION #1 - Frame AA, CC, or FF with US Hangers

- Wire provided by others
- Must securely hang from upper structure
- US Hangers installed individually on each side of DFL
- See DFL submittal for dimension of visible flange

### OPTION #2 - Frame AA, CC, or FF with UC Hangers

- Wire provided by others
- Must securely hang from upper structure
- UC Hanger attaches to both sides of DFL
- UC Hanger must be installed outside of plenum ends or in gaps between plenums
- See DFL submittal for dimension of visible flange



## FRAME DETAIL

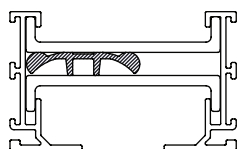

**FRAME AA**  
No Overlapping Flange

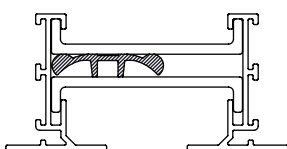

**FRAME CC**  
3/16" Overlapping Flange

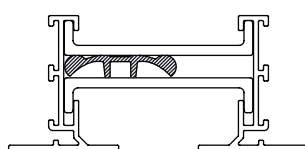

**FRAME FF**  
1/2" Overlapping Flange

## HANGER DETAIL

